

Viola Park Kitchen System Components

This is a general overview. Please see the pricelist for a complete listing of the available components

Standard width increments for base, wall and pantry units:
12", 15", 18", 21", 24", 27", 30", 32", 36", 42"

Select horizontal wall units are also available in:
48", 60", 72", 84"

Component	Description	Available Materials / Finishes
-----------	-------------	--------------------------------

Doors

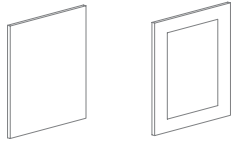

Flat Front door Frame & Panel door

Flat Front and Frame & Panel doors are available

Flat Front Doors: pigmented lacquer, VGC bamboo, chestnut strand bamboo (for base and wall units only)

Frame & Panel Doors: pigmented lacquer, walnut or rift cut oak - with solid or glass panels

Base Units: 30" tall 2 depths: 24 5/8", 18"

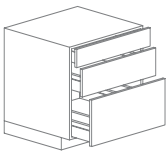

Base unit with drawers

Base Units With Drawers

- 2 drawer base
- 3 drawer base
- 4 drawer base

Base Cabinet Bodies: laminate on 3/4" green board - 3/4" backs on all cabinets

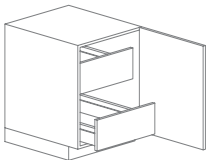

Base unit with doors

Base Units With Doors*

- Leaf door base with 2 interior drawers
- Leaf door base with 3 interior drawers
- Leaf door base with adjustable shelves inside (not shown)
- * Units wider than 24" have two doors

Flat Front Doors and Drawer Fronts: pigmented lacquer, VGC bamboo, chestnut strand bamboo

Frame & Panel Doors and Drawer Fronts: pigmented lacquer, walnut or rift oak

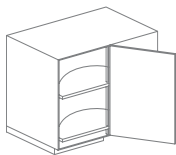

Corner unit

Corner Unit

Corner unit with rotating storage access - 18", 21" wide

Component

Description

Available Materials / Finishes

Special Purpose Base Units

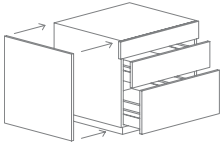

End unit left

End Unit- used to finish the end of a run, includes end panel

Base Cabinet Bodies: laminate on 3/4" green board - 3/4" backs on all cabinets

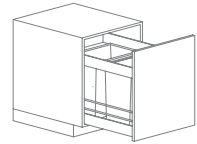

Trash unit

Trash Units

Single Trash Unit - (1) 40 L bin

Double Trash Unit - (2) 35 L bins (not shown)

Flat Front Doors and Drawer Fronts: pigmented lacquer, VGC bamboo, chestnut strand bamboo

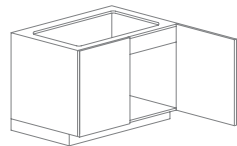

Sink unit with doors

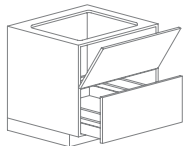

Sink unit with flip

Sink Units

Sink unit with 1 doors (not shown)

Sink unit with 2 doors

Sink unit with 1 drawer and flip down above

Frame & Panel Doors and Drawer Fronts: pigmented lacquer, walnut or rift oak

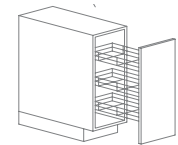

Pantry unit

Base Pantry and Bookshelf Units

Pantry Pullout Unit

Open Accent Unit with wood drawers

Bookshelf Unit- 2 depths: 12", 18"



Open accent unit

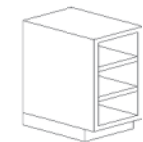

Bookshelf unit

Component

Description

Available Materials / Finishes

Special Purpose Base Units Continued

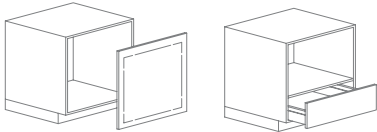

Oven unit- unfitted

Oven unit-fitted

Appliance Units

Oven Unit- unfitted and fitted for select models
Cooktop Unit with 2 drawers (not shown)
Cooktop Unit with leaf doors (not shown)
Undercounter Microwave Unit (not shown)

Dishwasher Front Panels*

Front Panel for 24" European dishwasher
Front Panel for 24" US dishwasher
Front Panel for 18" Miele dishwasher

* See panel section

Base Cabinet Bodies: laminate on 3/4" green board - 3/4"
backs on all cabinets

Flat Front Doors and Drawer Fronts: pigmented lacquer, VGC
bamboo, chestnut strand bamboo

Frame & Panel Doors and Drawer Fronts: pigmented lacquer,
walnut or rift oak

Horizontal Wall Units: 14 7/8" deep

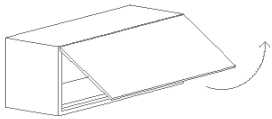

Horizontal wall unit with flip-up door

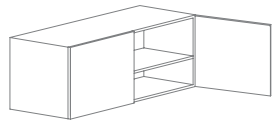

Horizontal wall unit with leaf doors

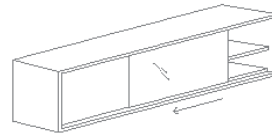

Horizontal wall unit with glass sliding door

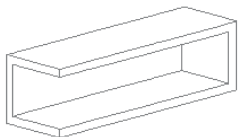

'C' Unit

Horizontal Wall Units - 16", 22" tall

Flip-up Door
Leaf Doors*
Glass Sliding Doors
Open Unit
16" tall thick 'C' Unit
Concealed Hood Vent Unit (not shown)
*Units wider than 24" have 2 doors

Cabinet Bodies: pigmented lacquer, walnut or rift oak
veneer, VGC bamboo

Flat Front Doors: pigmented lacquer, VGC bamboo,
chestnut strand bamboo

Frame & Panel Doors: pigmented lacquer, walnut or rift
oak - with solid or glass panels

Component

Description

Available Materials / Finishes

Medium and Tall Wall Units - 14 7/8" deep

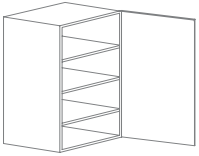

Medium height vertical unit

Medium Height Vertical Units - 24" tall
Leaf Door(s)*
Open Unit with adjustable shelves
Concealed Hood Vent Unit
* Units wider than 24" have two doors

Cabinet Bodies: pigmented lacquer, walnut or rift oak veneer, VGC bamboo, chestnut strand bamboo

Flat Front Doors: pigmented lacquer, VGC bamboo

Frame & Panel Doors: pigmented lacquer, walnut or rift oak - with solid or glass panels

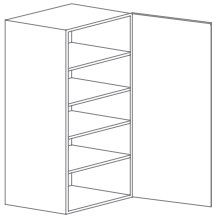

Pantry unit - 54"

Tall Height Vertical Units - 30", 36", 42" tall
Leaf Door(s)*
Open Unit with adjustable shelves
Concealed Hood Vent
* Units wider than 24" have two doors

Pantry Units with Leaf Door(s)

30" tall, adjustable shelves or 2 interior drawers
54" tall, adjustable shelves
72", 84", 90" tall, with 2 interior drawers at bottom and adjustable shelves above

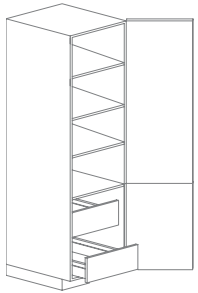

Pantry unit with drawers- 84"

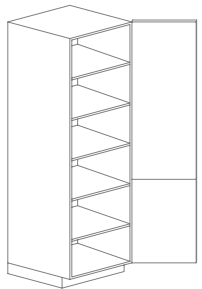

Pantry unit with adjustable shelves- 84"

Component

Description

Available Materials / Finishes



Open unit

Open Tall Units: 8", 12 3/4" deep
Open unit with fixed shelves : 54", 72" 84", 94" tall

Cabinet Bodies: pigmented lacquer, walnut or rift oak veneer, VGC bamboo

Flat Front Doors: pigmented lacquer or VGC bamboo

Frame & Panel Doors: pigmented lacquer, walnut or rift oak

Oven Stacks

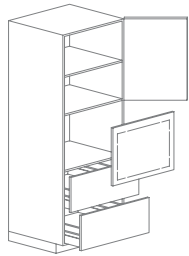

Oven stack - unfitted

Oven Stacks
Single Oven unit available unfitted and fitted for a select number of recommended models

Double Oven (not shown)

Cabinet Bodies: pigmented lacquer, walnut or rift oak veneer, VGC bamboo

Flat Front Doors: pigmented lacquer or VGC bamboo

Frame & Panel Doors: pigmented lacquer, walnut or rift oak

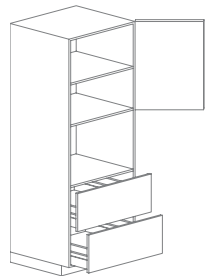

Oven stack- fitted

Component

Description

Available Materials / Finishes

Shelving



Floating shelf

Floating Shelf (includes hardware for installing)
Available in 5", 8", 12" depths

Floating Shelf: pigmented lacquer, VGC bamboo, walnut and rift oak veneer

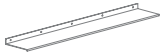

"Z" shelf

Floating "Z" Shelf
Available in 5", 8", 12" depths

"Z" Shelf: powdercoated steel.

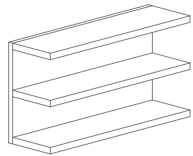

Shelf bank

Shelf Banks
Back panels available with 8, 12" deep shelves

Shelf Bank: pigmented lacquer with veneer shelves, VGC bamboo and strand bamboo with pigmented lacquer shelves

Panels



End panel

Cabinet Panels
Base Run End Panel
Tall Unit End Panel
Island or Peninsula Panel

Panels: pigmented lacquer, walnut or rift oak veneer, VGC bamboo, strand bamboo (not available over 70" tall)

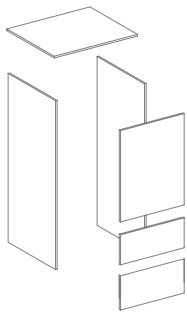

Refrigerator wrap

Dishwasher Panels
Front Panel for 24" European dishwasher
Front Panel for 24" US dishwasher
Front Panel for 18" Miele dishwasher

Refrigerator Panels and Kits
Universal Wrap Kit- top and side panels to be sized at installation
Overlay Front Panel Kit - Subzero, Thermador, Bosch, Leibherr

Wall Panels
Backsplash Panel
Cleated Wall Panel
Aluminum Backsplash Panel

Custom Panels are available to your specific dimensions - max 48" x 96"

Component

Description

Available Materials / Finishes

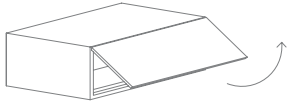

Above Refrigerator Unit

Above Refrigerator Unit - 12", 22" Tall
Available Widths - 24", 30", 32", 36"
Depth 24 5/8" depth
Flip-up door

Cabinet Bodies: pigmented lacquer, walnut or rift oak veneer, VGC bamboo

Flat Front Doors: pigmented lacquer, VGC bamboo, chestnut strand bamboo

Frame & Panel Doors: pigmented lacquer, walnut or rift oak - with solid or glass panels

Drawer Inserts

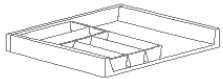

Utensil tray

Utensil Tray and Dividing System

Organizational accessories are designed to fit precisely within drawers. These accessories can be ordered individually based on your needs.

The drawer components are made of stainless steel with plastic fittings

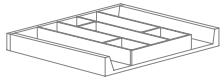

Dividing system

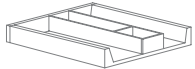

Dividing system

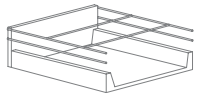

Rail unit organizer

Rail Unit Organizer

The rail unit can be adjusted to accommodate a range of storage requirements.

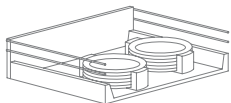

Plate organizer

Plate Organizers

Organizational accessories like these removable plate holders are designed to optimize storage. They are expandable so they can fit bowls to large dinner plates.

Pull Options

Viola Park Pulls are precision machined from solid aluminum. They have a clear anodized finish that hardens the aluminum, protecting them from scratching and wear, and maintaining the pull's luster.



Staple A

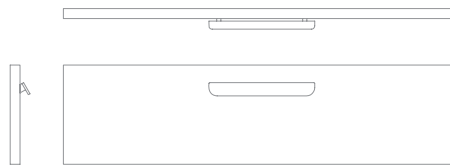

Staple D

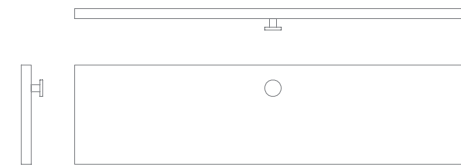

Knob A

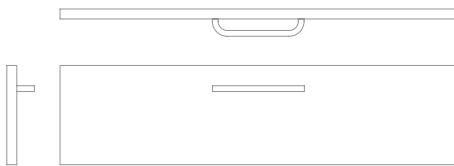

Staple C

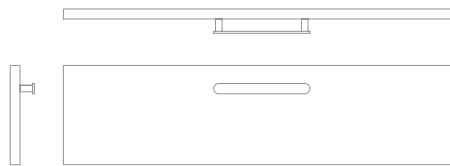

Staple B

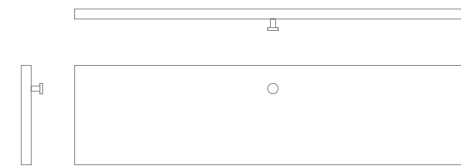

Knob A sm

