

# Viola Park Kitchen System Components

This is a general overview. Please see the pricelist for a complete listing of the available components.

Standard width increments for base, wall and pantry units:  
12", 15", 18", 21", 24", 27", 30", 32", 36", 42"

Select horizontal wall units are also available in:  
48", 60", 72", 84"

## Component

## Description

## Available Materials / Finishes

### Doors

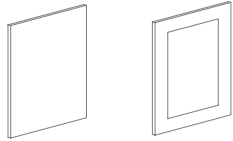

Flat Front door Frame & Panel door

Flat Front and Frame & Panel doors are available

Flat Front Doors: pigmented lacquer, walnut or rift cut oak, VGC bamboo, chestnut strand bamboo (for base and wall units only)

Frame & Panel Doors: pigmented lacquer, walnut or rift cut oak - with solid or glass panels

**Base Units: 30" tall**  
**2 depths: 24 5/8", 18"**

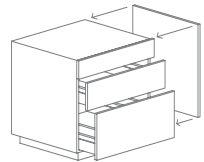

Base unit with drawers

Base Units With Drawers  
2 drawer base  
3 drawer base  
4 drawer base

Base Cabinet Bodies: laminate on 3/4" Evergreen Board  
- 3/4" backs on all cabinets

Flat Front Doors and Drawer Fronts: pigmented lacquer, walnut or rift cut oak, VGC bamboo, chestnut strand bamboo

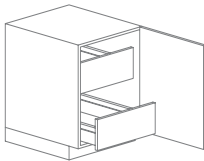

Base unit with doors

Base Units With Doors\*  
Leaf door base with 2 interior drawers  
Leaf door base with 3 interior drawers  
Leaf door base with adjustable shelves inside (not shown)  
\* Units wider than 24" have two doors

Frame & Panel Doors and Drawer Fronts: pigmented lacquer, walnut or rift oak

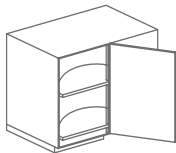

Corner unit

Corner Unit  
Corner unit with rotating storage access - 18", 21" wide

## Component

## Description

## Available Materials / Finishes

### Special Purpose Base Units

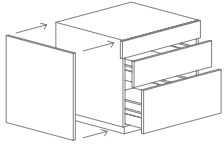

End unit left

End Unit- used to finish the end of a run, includes end panel

Base Cabinet Bodies: laminate on 3/4" Evergreen Board  
- 3/4" backs on all cabinets

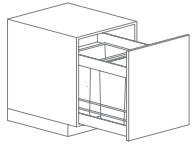

Trash unit

#### Trash Units

Single Trash Unit - (1) 40 L bin

Double Trash Unit - (2) 35 L bins (not shown)

Flat Front Doors and Drawer Fronts: pigmented lacquer,  
walnut or rift cut oak, VGC bamboo, chestnut strand bamboo

Frame & Panel Doors and Drawer Fronts: pigmented lacquer,  
walnut or rift oak

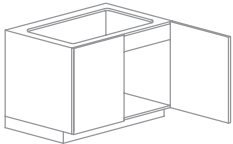

Sink unit with doors

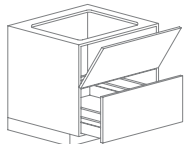

Sink unit with flip

#### Sink Units

Sink unit with 1 doors (not shown)

Sink unit with 2 doors

Sink unit with 1 drawer and flip down above

Optional: interior drawer

Note: units wider than 30" have 2 doors

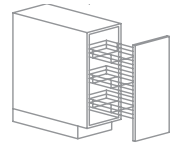

Pantry unit

Pantry Pullout Unit

Flat Front Doors and Drawer Fronts: pigmented lacquer,  
walnut or rift cut oak, VGC bamboo, chestnut strand bamboo

Frame & Panel Doors and Drawer Fronts: pigmented lacquer,  
walnut or rift oak

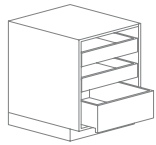

Open accent unit

Open Accent Unit with wood drawers - 2 depths: 18", 24"

Body: pigmented lacquer, walnut or rift cut oak,  
VGC bamboo, chestnut strand bamboo

Drawers: Same - but no drawers in chestnut strand bamboo

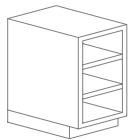

Bookshelf unit

Bookshelf Unit- 2 depths: 8", 12"  
1.5" thick walls and shelves

## Component

## Description

## Available Materials / Finishes

### Special Purpose Base Units Continued

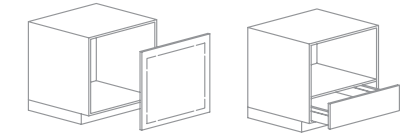

Oven unit- unfitted

Oven unit-fitted

#### Appliance Units

Oven Unit- unfitted and fitted for select models

Cooktop Unit with 2 drawers (not shown)

Cooktop Unit with leaf doors (not shown)

Undercounter Microwave Unit (not shown)

#### Dishwasher Front Panels\*

Front Panel for 24" European dishwasher

Front Panel for 24" US dishwasher

Front Panel for 18" Miele dishwasher

\* See panel section

Base Cabinet Bodies: laminate on 3/4" Evergreen Board  
- 3/4" backs on all cabinets

Flat Front Doors and Drawer Fronts: pigmented lacquer,  
walnut or rift cut oak, VGC bamboo, chestnut strand bamboo

Frame & Panel Doors and Drawer Fronts: pigmented lacquer,  
walnut or rift oak

### Horizontal Wall Units: 14 7/8" deep

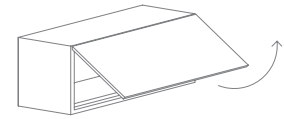

Horizontal wall unit with flip-up door

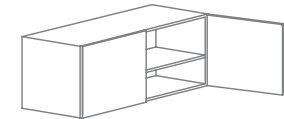

Horizontal wall unit with leaf doors

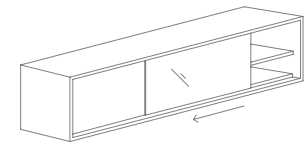

Horizontal wall unit with glass sliding door

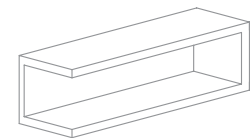

'C' Unit

Horizontal Wall Units - 16", 22" tall

Flip-up Door

Leaf Doors\*

Glass Sliding Doors

Open Unit

16" tall thick 'C' Unit

Concealed Hood Vent Unit (not shown)

\*Units wider than 24" have 2 doors

Cabinet Bodies: pigmented lacquer, walnut or rift oak  
vener, VGC bamboo

Flat Front Doors: pigmented lacquer, walnut or rift cut  
oak, VGC bamboo, chestnut strand bamboo

Frame & Panel Doors: pigmented lacquer, walnut or rift  
oak - with solid or glass panels

## Component

## Description

## Available Materials / Finishes

### Medium and Tall Wall Units - 14 7/8" deep

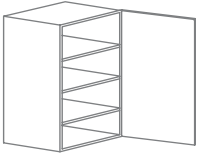

Medium height vertical unit

Medium Height Vertical Units - 24" tall  
Leaf Door(s)\*  
Open Unit with adjustable shelves  
Concealed Hood Vent Unit  
\* Units wider than 24" have two doors

Cabinet Bodies: pigmented lacquer, walnut or rift oak veneer, VGC bamboo, chestnut strand bamboo

Flat Front Doors: pigmented lacquer, walnut or rift cut oak, VGC bamboo

Frame & Panel Doors: pigmented lacquer, walnut or rift oak - with solid or glass panels

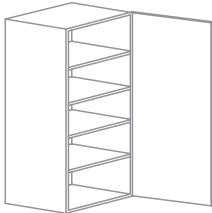

Pantry unit - 54"

Tall Height Vertical Units - 30", 36", 42" tall  
Leaf Door(s)\*  
Open Unit with adjustable shelves  
Concealed Hood Vent  
\* Units wider than 24" have two doors

Pantry Units with Leaf Door(s)  
30" tall, adjustable shelves or 2 interior drawers  
54" tall, adjustable shelves  
72", 84", 90" tall, with 2 interior drawers at bottom and adjustable shelves above

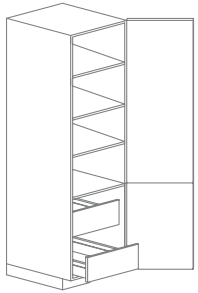

Pantry unit with drawers- 84"

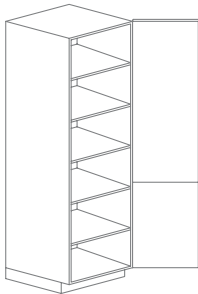

Pantry unit with adjustable shelves- 84"

## Component

## Description

## Available Materials / Finishes

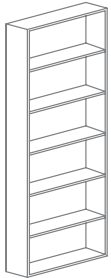

Open unit

Open Tall Units: 8", 12 3/4" deep  
Open unit with fixed shelves : 54", 72" 84", 94" tall

Cabinet Bodies: pigmented lacquer, walnut or rift oak veneer, VGC bamboo

Flat Front Doors: pigmented lacquer, walnut or rift cut oak, or VGC bamboo

Frame & Panel Doors: pigmented lacquer, walnut or rift oak

## Oven Stacks

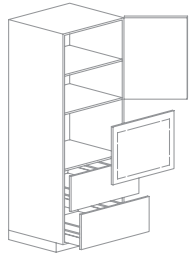

Oven stack - unfitted

Oven Stacks  
Single Oven unit available unfitted and fitted for a select number of recommended models

Double Oven (not shown)

Cabinet Bodies: pigmented lacquer, walnut or rift oak veneer, VGC bamboo

Flat Front Doors: pigmented lacquer, walnut or rift cut oak, or VGC bamboo

Frame & Panel Doors: pigmented lacquer, walnut or rift oak

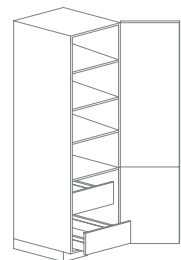

Oven stack- fitted

## Component

## Description

## Available Materials / Finishes

### Shelving



Floating shelf

Floating Shelf (includes hardware for installing)  
Available in 5", 8", 12" depths

Floating Shelf: pigmented lacquer, VGC bamboo, walnut and rift oak veneer

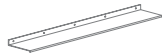

"Z" shelf

Floating "Z" Shelf  
Available in 5", 8", 12" depths

"Z" Shelf: powdercoated steel.

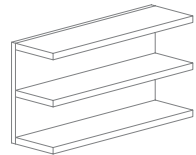

Shelf bank

Shelf Banks  
Back panels available with 8, 12" deep shelves

Shelf Bank: pigmented lacquer with veneer shelves, VGC bamboo and strand bamboo with pigmented lacquer shelves

### Panels

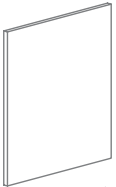

End panel

Cabinet Panels  
Base Run End Panel  
Tall Unit End Panel  
Island or Peninsula Panel

Panels: pigmented lacquer, walnut or rift oak veneer, VGC bamboo, strand bamboo (not available over 70" tall)

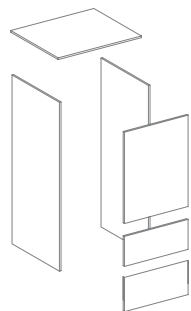

Refrigerator wrap

Dishwasher Panels  
Front Panel for 24" European dishwasher  
Front Panel for 24" US dishwasher  
Front Panel for 18" Miele dishwasher

Refrigerator Panels and Kits  
Universal Wrap Kit- top and side panels to be sized at installation  
Overlay Front Panel Kit - Subzero, Thermador, Bosch, Leibherr

Wall Panels  
Backsplash Panel  
Cleated Wall Panel  
Aluminum Backsplash Panel

Custom Panels are available to your specific dimensions - max 48" x 96"

## Component

## Description

## Available Materials / Finishes

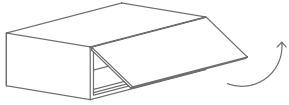

Above Refrigerator Unit

Above Refrigerator Unit - 12", 22" Tall  
Available Widths - 24", 27", 30", 32", 36"  
Depth 24 5/8" depth  
Flip-up door

Cabinet Bodies: pigmented lacquer, walnut or rift oak veneer, VGC bamboo

Flat Front Doors: pigmented lacquer, walnut or rift cut oak, VGC bamboo, chestnut strand bamboo

Frame & Panel Doors: pigmented lacquer, walnut or rift oak - with solid or glass panels

## Fall 2010 Product Additions

### Countertops



Above Refrigerator Unit

Pre-cut solid countertops with integrated backstop strip.  
Sized to kitchen layout.  
Includes installation kit.

1/2" Corian  
1/2" LG solid surface  
1/2" Paperstone  
3/4" Paperstone

### Islands

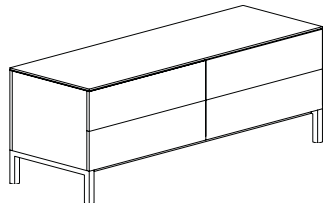

Fixed Elevated Island Unit

Multiple island configurations can be produced using standard Viola Park components. Your coordinator will help you with this.

In addition, in Fall of 2010, we are offering an elevated island, which can be either stationary or mobile. The island consists of:

- A steel base, including wheels if selected
- Up to 3 storage units
- A subcounter trim kit
- Countertop

No additional panels are required.

Flat Front Doors: pigmented lacquer, walnut or rift cut oak, VGC bamboo, chestnut strand bamboo (for base and wall units only)

Frame & Panel Doors: pigmented lacquer, walnut or rift cut oak - with solid or glass panels

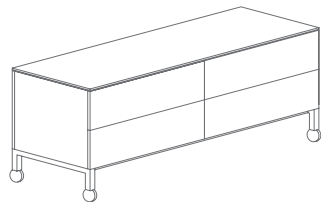

Mobile Elevated Island Unit

## Drawer Inserts

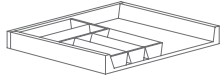

Utensil tray

### Utensil Tray and Dividing System

Organizational accessories are designed to fit precisely within drawers. These accessories can be ordered individually based on your needs.

The drawer components are made of stainless steel with plastic fittings

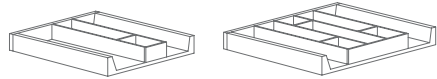

Dividing system

### Rail Unit Organizer

The rail unit can be adjusted to accommodate a range of storage requirements.

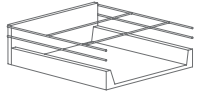

Rail unit organizer

### Plate Organizers

Organizational accessories like these removable plate holders are designed to optimize storage. They are expandable so they can fit bowls to large dinner plates.

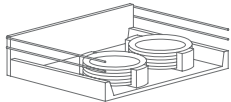
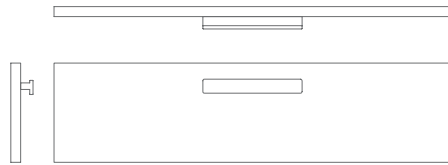

Plate organizer



## Pull Options

Viola Park Pulls are precision machined from solid aluminum. They have a clear anodized finish that hardens the aluminum, protecting them from scratching and wear, and maintaining the pull's luster.



**Staple A**

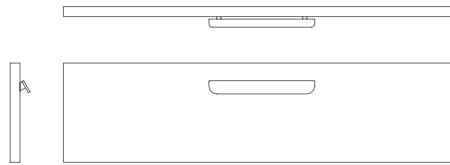

**Staple D**

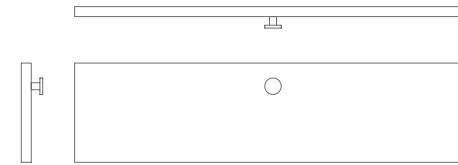

**Knob A**

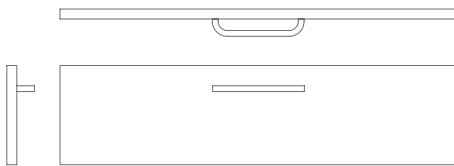

**Staple C**

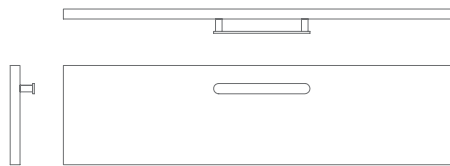

**Staple B**

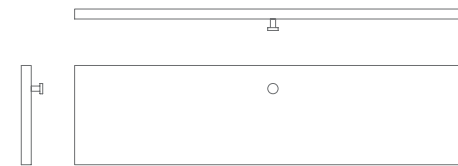

**Knob A sm**

